



City of Miami Gardens  
Planning and Zoning Division  
18605 NW 27<sup>th</sup> Avenue  
Miami Gardens, FL 33056

## CHILDCARE & EDUCATIONAL FACILITIES ZONING REQUIREMENTS CHECKLIST

### DEFINITION (Section 34-733)

The term “private school” or “nonpublic educational facility” shall mean an institution which provides child care and/or instruction from the infant level through the college level and which does not come under the direct operation and administration of the Miami-Dade County School Board or the State of Florida; only such uses are intended to be controlled by this article and include, but are not limited to, the following:

- (a) *Day nurseries, more than five children:* Child care for infants and children up to and including age six.
- (b) *Kindergartens, more than five children:* Child care and preschool programs for children ages four through six.
- (c) *After-school care, more than five children:* Child care and recreation for children above the age of five when no formal schooling program is conducted and where the care provided is generally after school, on weekends, school holidays and vacations.
- (d) *Babysitting service for shoppers:* Child care for limited time periods (maximum three hours) provided within a shopping center solely for the convenience of the patrons, and limited to not more than 40 children at any one time.
- (e) *Private school:* This term as used herein refers to any private institution providing child care and/or instruction at any level from infants through the college level.
- (f) *Elementary, junior and senior high schools:* References to these schools are to be loosely interpreted to encompass any schools, graded, whose students are within the age ranges typically found at these school levels, County-approved charter schools shall be considered as a private educational facility.
- (g) *Family day care home, more than five children:* An occupied residence in which child care is regularly provided for children unrelated to the residents of the premises by a resident of the premises, which receives a payment, fee, or grant for any of the children receiving care, whether or not operated for profit, and may be regulated by F.S. § 402.313 and registered or licensed with the Department of Children and Family Services in compliance with state law. Excludes private residences used for an informal cooperative arrangement among neighbors or relatives, or the occasional care of children with or without compensation.
- (h) *Charter school:* A school that teaches state-approved academic curriculum to children at the kindergarten through 12<sup>th</sup> grade levels that is an accredited charter school in the county.

**Combination of residential and nonpublic educational facilities and child care facility Prohibited, except for.**

- 1) A single-family residential use is permitted in the same building with a nursery, after school care or kindergarten use, where the same is used only by the nursery-kindergarten operator;
- 2) In connection with day nursery, after school care and kindergarten facilities, a residential unit for a caretaker is permitted only when the facility operator does not reside on said premises.
- 3) A residential unit is permitted for a caretaker on the site of an elementary, junior and/or senior high school.
- 4) An existing multifamily apartment building or complex may incorporate an educational and child care facility will not be contrary to any site plans previously approved at a public hearing.

**Physical standards:**

- 1) *Recreation/play areas.* Recreation/play areas shall be in accordance with the following minimum standards, calculated in terms of the proposed maximum number of children for attendance at the school at the school at any one time unless otherwise indicated. Recreation/play areas may be provided within an enclosed air-conditioned area or outdoors or a combination of both. If located outside, recreation and/or play areas shall be enclosed with fences and/or walls.

Table 2: Minimum Standards for Recreation Playground/Play Areas	
School categories	Required area
Day care/kindergarten and preschool, after-school care, family day care home	Forty-five square feet per child calculated in terms of half of the proposed maximum number of children for attendance at the school at one time
Elementary school (grades 1-6)	Five hundred squared feet per student for the first 30 students; thereafter, 300 square feet per student
Junior and senior high school (grades 7-12)	Eight hundred squared feet per student for the first 30 students; 300 square feet per student for the next 300 students; thereafter, 150 square feet per student

- 2) Auto stacking. Stacking space, defined as that space in which pickup and delivery of children can take place, shall be provided for a minimum of two automobiles for schools with 20 to 40 children; schools with 40 to 60 [children] shall provide four spaces; thereafter there shall be provide a space sufficient to stack five automobiles.
- 3) Classroom size. This space shall not include kitchen areas, bathrooms, hallways, teachers' conference rooms, storage areas, or any other interior space that is not used for instruction, play or other similar activities.
  - a) Day nursery and kindergarten, preschool and afterschool care, 35 square feet per pupil.
  - b) Elementary (grades 1-6), 30 square feet per pupil.
  - c) Junior high and senior high (grades 7-12), 25 square feet pupil.
  - d) Babysitting service, 22 square feet of room area per child.

**All nonpublic educational facilities and child care facilities requesting approval shall submit A DETAILED PLOT USE PLAN similar to sample provided below.**

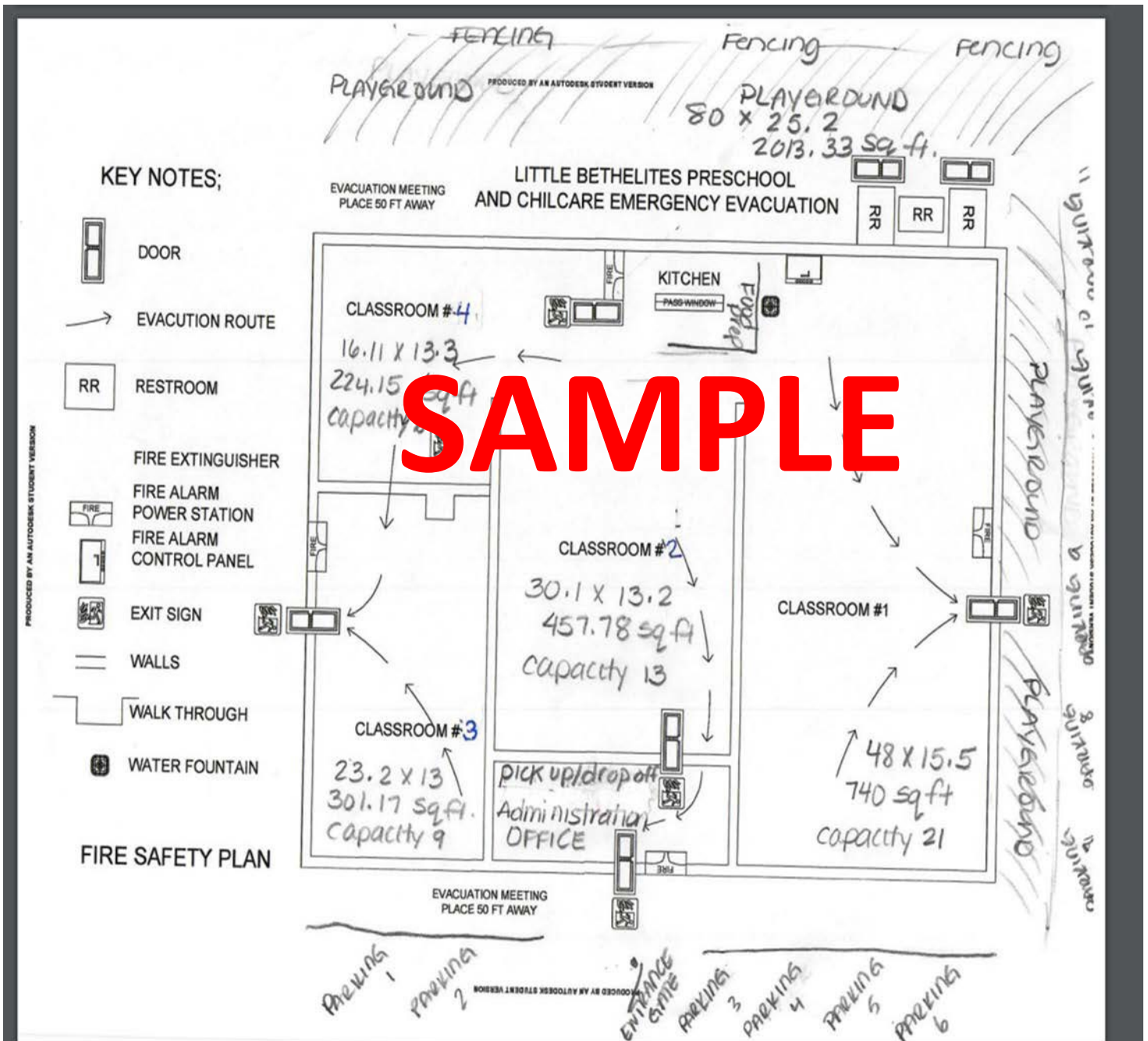

# EDUCATIONAL AND CHILDCARE FACILITIES FORM

## GENERAL INFORMATION:

School Name: \_\_\_\_\_

School Address: \_\_\_\_\_

Folio Number: \_\_\_\_\_

Is this an expansion to an existing school? Yes \_\_\_\_\_ No \_\_\_\_\_ If yes, indicate originally approved number of students: \_\_\_\_\_ and grade ranges: \_\_\_\_\_

## List number of proposed students by grade ranges:

Daycare/Kindergarten/Preschool \_\_\_\_\_ Aftercare \_\_\_\_\_ Elementary \_\_\_\_\_ Junior & Senior \_\_\_\_\_

Does the subject facility share the site with other facilities? Yes \_ No \_\_\_\_ (If yes, the space which will be used solely for the school facility during the hours of operation must be indicated on the plans, pursuant to Section 34- 288 (20) (e).

If the school will include residential uses, do such uses meet the standards provided in Section 34-288 (20) (f)

Yes \_\_\_\_ No \_\_\_\_ (If yes, describe the residential uses and indicate same on the plans.)

EDUCATIONAL AND CHILDCARE FACILITIES MATRIX		
Total size of the site:		
Maximum enrollment:		
Number of teachers and administrative personnel:		
Number of classrooms:		
<b>Total square footage of classroom space:</b>	<b>Number of Students per grade</b>	<b>Square footage provided for classroom for each grade</b>
• Daycare/kindergarten, preschool, and afterschool care.		
• Elementary (grades 1-6)		
• Junior high and senior high (7-12)		
• Babysitting service		
<b>Total square footage of non-classroom space:</b>		
<b>Total square footage of recreation/play area:</b>	<b>Number of Students per grade</b>	<b>Square footage provided for recreation for each grade</b>
* Recreation/play areas may be provided within an enclosed airconditioned area or outdoors or a combination of both		

• Daycare/kindergarten and preschool and afterschool care.		
• Elementary (grades 1-6)		
• Junior high and senior high (7-12)		
• Babysitting service.		
<b>Transportation &amp; Parking</b>		
Number and types of transportation vehicles:		
Number of parking spaces for staff:		
Number of parking spaces for visitors:		
Number of parking spaces for transportation:		
Number of auto-stacking spaces:		

**THE INFORMATION ABOVE IS COMPLETE AND IS CORRECT TO THE BEST OF MY KNOWLEDGE.**

Applicant Signature: \_\_\_\_\_

Print Name: \_\_\_\_\_

Sworn to and subscribed before me on the \_\_\_\_\_ day of \_\_\_\_\_

Personally known to me \_\_\_\_\_ Produced Identification \_\_\_\_\_

Type of Identification \_\_\_\_\_

Notary

(Stamp/Seal)

Commission Expires:

**OFFICE USE ONLY**

\_\_\_\_\_ Educational facility referenced above meets the required minimum standard, therefore **SATISFIES** the classroom and recreational criteria of Section 34-733 of the City's Land Development Regulations.

**Approved number of students by grade ranges:**

Daycare \_\_\_\_\_ Preschool \_\_\_\_\_ Aftercare \_\_\_\_\_ Kindergarten \_\_\_\_\_ Elementary \_\_\_\_\_

Junior & Senior \_\_\_\_\_

Reviewer Signature: \_\_\_\_\_ VERIFICATION Date: \_\_\_\_\_

Revised 2 /6/2025